

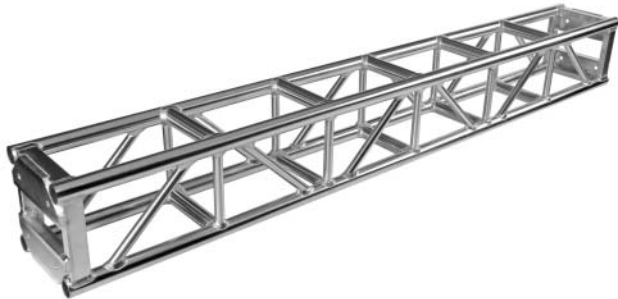

### PLATED FEATURES

Highly Polished Aluminum Tubing  
 1.9" OD 6061-T6 Aluminum Tube Schd #40  
 0.145" Wall Thickness  
 1.05" OD Aluminum Bracing  
 Fabricated By Certified Welders  
 Custom Lengths & Corners Available  
 Powder Coating Available



Applied Electronics Heavy Duty 12" Box Truss is manufactured with schedule 40, 1.9" OD x 0.145" wall main chords and 1.05" OD x 0.125" wall diagonal bracing. All components are 6061-T6 aluminum tubing and 5/8" grade 8 bolts are supplied for assembly of the truss elements. Heavy Duty 12" truss, combined with the matching corner blocks, can be used to construct a grid.

### PLATED ORDERING INFORMATION

Item No.	Dimensions	Weight
9-12-120	12" x 12" x 10'	62 lbs.
9-12-096	12" x 12" x 8'	47 lbs.
9-12-060	12" x 12" x 5'	36 lbs.
9-12-030	12" x 12" x 2.5'	24 lbs.
9-12-004	4-Way Corner	20 lbs.
9-12-005	5-Way Corner	25 lbs.

#### PLATED ALLOWABLE LOAD DATA

SPAN (ft.)	Maximum Allowable Uniform Loads			Maximum Allowable Center Point Loads		L/180
	LOAD (#/ft.)	LOAD (#)	MAX. DEFL. (in.)	LOAD (#)	MAX. DEFL. (in.)	
10	400	4000		3000	0.67	
20	120	2400		1800	1.33	
30	50	1500		800	2.00	
40	18.75	750		500	2.67	

Connection: 5/8" Dia. x 2" Grade 8 Bolts  
 Weight Load Certified By Structural Engineer

### SPIGOTED FEATURES

Highly Polished Aluminum Tubing  
 1.9" OD 6061-T6 Aluminum Tube Schd #80  
 0.200" Wall Thickness  
 1.05" OD Aluminum Bracing  
 Steel Spigots and Pins  
 Fabricated By Certified Welders  
 Custom Lengths & Corners Available  
 Powder Coating Available

### SPIGOTED ORDERING INFORMATION

Item No.	Dimensions	Weight
13-11-120	12" x 12" x 10'	81 lbs.
13-11-096	12" x 12" x 8'	65 lbs.
13-11-060	12" x 12" x 5'	39 lbs.
13-11-030	12" x 12" x 2.5'	30 lbs.
13-11-002	2-Way Corner	30 lbs.
13-11-004	4-Way Corner	35 lbs.
13-11-005	5-Way Corner	45 lbs.

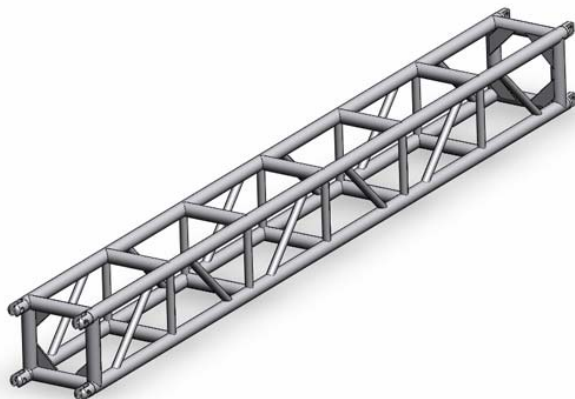

#### SPIGOTED ESTIMATED LOAD DATA

SPAN (ft.)	Maximum Allowable Uniform Loads			Maximum Allowable Center Point Loads	
	LOAD (#/ft.)	LOAD (#)	MAX. DEFL. (in.)	LOAD (#)	MAX. DEFL. (in.)
10	481	4813		3587	
20	177	3542		1726	
30	76	2286		1076	
40	41	1636		728	

Connection: Steel Spigots and 3/4" x 2-1/2" Clevis Pins